

# TITAN

## Petrol Hedge Trimmer (26 cm<sup>3</sup>)

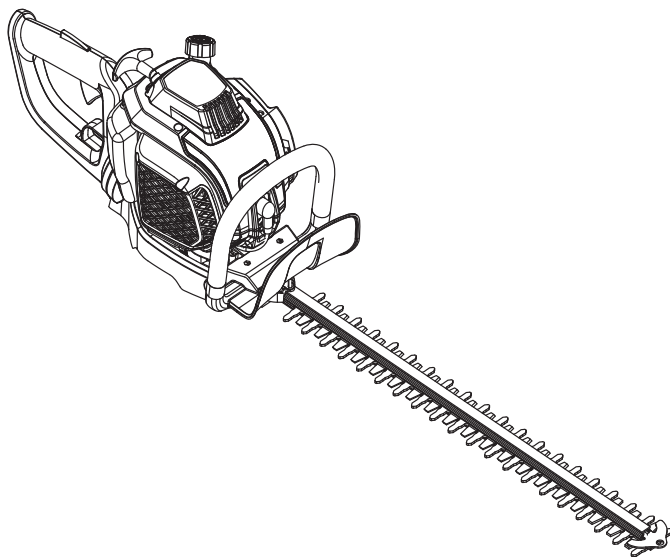

Original Instructions – TTHTP26\_V10821

# TTHTP26

EAN: 5059340124346

BX220IM



**WARNING:** Read the instructions before using the machine.



Congratulations on your purchase of a **TITAN** power tool from Kingfisher International Products Limited. We want you to continue getting the best performance from it so this handbook includes information on safety, handling and care. Please retain this handbook in case you need to refer to any of the information in the future.

Your **TITAN** power tool comes with a 2-year guarantee. Should it develop a fault within this period please do not return it to Store. Please contact the Titan 2 Stroke Helpline on: 0333 2000 339 in the first instance.

## Guarantee

---

This **TITAN** product carries a guarantee of 2 year. If your product develops a fault within this period, you should, in the first instance contact: 0333 2000 339 (Mon-Fri: 09.00-17.00)

This guarantee specifically excludes losses caused due to:

- Fair wear and tear
- Misuse or abuse
- Lack of routine maintenance
- Failure of consumable items (such as batteries)
- Accidental damage
- Cosmetic damage
- Failure to follow manufacturer's guidelines
- Loss of use of the goods

This guarantee does not affect your statutory rights. This guarantee is only valid in the UK.

For any enquiries relating to the guarantee please refer to your retailer.

**Should you experience any issues with this Titan product, please do not return it to Store. Please contact the Titan 2 Stroke Helpline on: 0333 2000 339 or email [cs@b-gr8.co.uk](mailto:cs@b-gr8.co.uk)**

# Let's get started...

These instructions are for your safety. Please read through them thoroughly before use and retain them for future reference.



## Getting **Started...**

03

**Safety** information 04**Your** equipment 13**Before you start** 15**Quick start** 19

## In more detail...

22

**Equipment** functions 22**Operation** 23**Care and maintenance** 28**Troubleshooting** 36**Recycling and disposal** 37**EC declaration of conformity** 38

## Safety warnings

### **IMPORTANT READ CAREFULLY BEFORE USE KEEP FOR FUTURE REFERENCE**

1. This equipment is not intended for use by children and persons with reduced physical, sensory or mental capabilities, or lack of experience and knowledge.
2. Children should be supervised to ensure that they do not play with the equipment.



**WARNING!** Your safety and the safety of others is very important. Of course, it is not practical or possible to warn you about all the hazards associated with operating or maintaining this equipment. At all times you must use your own good judgment.

### **Training**

Read the instructions carefully. Become familiar with the instructions before attempting to operate the equipment.

### **Preparation**

1. **THIS HEDGE TRIMMER CAN CAUSE SERIOUS INJURIES.** Read the instructions carefully for the correct handling, preparation, maintenance, starting and stopping of the hedge trimmer. Become familiar with all controls and the proper use of the hedge trimmer.
2. Never allow children to use the hedge trimmer.
3. Beware of overhead power lines.
4. Avoid operating while people, especially children, are nearby.
5. Dress properly! Do not wear loose clothing or jewellery, which can be caught in moving parts. Use of sturdy gloves, non-slip footwear and safety glasses is recommended.
6. Use the following personal protective equipment (PPE) when operating the equipment:
  - Ear protection (compliant to EN 352-1)
  - Eye protection (compliant to EN 166)
  - Protective gloves (compliant to EN ISO 21420 Class 0)
  - First Aid Kit in case of injury
  - Dry powder fire extinguisher readily available

7. Use extra care when handling fuels. Fuel is flammable and the vapours are explosive. The following points should be observed.
  - Use only an approved container.
  - Never remove the fuel cap or add fuel with the power source running. Allow engine and exhaust components to cool down before refuelling.
  - Do not smoke.
  - Never refuel indoors.
  - Never store the hedge trimmer or fuel container inside where there is an open flame, such as near a water heater.
  - If fuel is spilled, do not attempt to start the power source, but move the hedge trimmer away from the spillage before starting.
  - Always replace and securely tighten the fuel cap after refuelling.
  - If the fuel tank is drained, this should be done outdoors.
8. If the cutting mechanism strikes any foreign object or the hedge trimmer starts making any unusual noise or vibration, shut off the power source and allow the hedge trimmer to stop. Disconnect the spark plug wire from the spark plug and take the following steps.
  - Inspect for damage.
  - Check for, and tighten, any loose parts.
  - Have any damaged parts replaced or repaired with parts having equivalent specifications.
9. In an emergency: stop the engine by immediately releasing the throttle control and set the stop switch to "STOP" position.

## Operation

1. Stop the engine before:
  - cleaning or when clearing a blockage;
  - checking, carrying out maintenance or working on the hedge trimmer;
  - adjusting the working position of the cutting device;
  - leaving the hedge trimmer unattended.
2. Ensure that the hedge trimmer is correctly located in a designated working position before starting the engine.
3. While operating the hedge trimmer, always ensure that the operating position is safe and secure, especially when using steps or a ladder.
4. Do not operate the hedge trimmer with a damaged or excessively worn cutting device.
5. To reduce fire hazards, keep the engine and silencer free of debris, leaves and excessive lubricant.
6. Always ensure that all handles and guards are fitted when using the hedge trimmer. Never attempt to use an incomplete hedge trimmer or one fitted with an unauthorized modification.
7. Always use two hands to operate a hedge trimmer.

8. Always be aware of your surroundings and stay alert for possible hazards of which you might not be aware due to the noise of the hedge trimmer.
9. Keep all parts of the body away from the cutting blade. A moment of inattention while operating the hedge trimmer may result in serious personal injury.

**Maintenance and storage**

1. When the hedge trimmer is stopped for servicing, inspection or storage, shut off the power source, make sure all moving parts have come to a stop and disconnect the spark plug wire from the spark plug. Allow the hedge trimmer to cool before making any inspections, adjustments, etc.
2. Store the hedge trimmer where the fuel vapour will not reach an open flame or spark. Always allow the hedge trimmer to cool down before storing.
3. When transporting or storing the hedge trimmer, always fit the cutting device transport guard.
4. Empty the fuel tank after every use. Run the product dry of fuel in idle before storage.
5. Dispose of waste oil and fuel at a local petrol station, local authority centre or where facilities exist.

**Additional fuel handling tips**

1. Always switch the equipment off, disconnect the spark plug wire and let the equipment cool down before refuelling it.
2. Fuel and fuel vapour are highly flammable. Take care when handling fuel.
3. Always use suitable aids such as funnels and filler necks. Do not spill any fuel on the equipment or its exhaust system. There is a risk of ignition. Remove spilled fuel carefully from all parts of the equipment. Any residue which may be present must have completely volatilised, before the equipment is put into operation!
4. Never use the equipment in environments where there is a risk of explosion. Exhaust gases and fuel fumes are noxious. Fuel fumes can ignite.
5. Avoid skin contact with petrol.
6. Do not eat or drink, while you are refuelling the equipment. If you have swallowed petrol or oil, or if petrol or oil has got into your eyes, then seek the advice of a doctor immediately.
7. Fuel vapour pressure may build up inside the fuel tank depending on the fuel used, weather conditions and the tank venting system. To reduce the risk of burns and other personal injuries, remove the fuel tank cap carefully to allow any pressure build up to release slowly.
8. Ensure the spark plug wire is secure. Loosen wire may cause electrical arcing that could ignite combustible fumes and cause a fire or explosion.
9. Use caution when handling fuel. To avoid any accidental fires, move the equipment at least 3 metres from the fuelling point before starting the engine.
10. Do not operate the equipment if it is leaking fuel.
11. Do not remove the fuel tank cap while the engine is running.

12. Do not store cans of fuel or refill the fuel tank in any place where there is a boiler, stove, wood fire, electrical sparks, welding sparks, or other sources of heat or fire which might ignite the fuel.
13. If any fuel spillage occurs during refuelling, use a dry rag to wipe up spills and allow remaining fuel to evaporate before starting the engine on again.
14. If you have spilt fuel on yourself or on your clothes, change your clothes and wash any part of your body that has come in contact with fuel before turning the engine on again.
15. If fuel has ignited, put out the fire with a dry powder fire extinguisher.
16. Never breathe in any fuel fumes, when you are refuelling the equipment.
17. Keep fuel fresh (less than 30 days) or add fuel stabiliser.

### **Vibration and noise reduction**

**To reduce the impact of noise and vibration emission, limit the time of operation, use low-vibration and low-noise operating modes as well as wear personal protective equipment.**

Take the following points into account to minimise the vibration and noise exposure risks:

1. Only use the equipment as intended by its design and these instructions.
2. Ensure that the equipment is in good condition and well maintained.
3. Use correct attachments for the equipment and ensure they in good condition.
4. Keep a tight grip on the handles/gripping surfaces.
5. Maintain this equipment in accordance with these instructions and keep it well lubricated (where appropriate).
6. Plan your work schedule to spread any high vibration tool use across a longer period of time.

### Emergency

**Familiarise yourself with the use of this equipment by means of this instruction manual. Memorise the safety directions and follow them to the letter. This will help to prevent risks and hazards.**

1. **Always be alert when using this equipment, so that you can recognise and handle risks early.** Fast intervention can prevent serious injury and damage to property.
2. **Stop the engine and disconnect the spark plug wire if there are malfunctions.** Have the equipment checked by a qualified professional and repaired, if necessary, before you operate it again.
3. **In case of fire stop the engine and disconnect the spark plug wire.** Take fire-extinguishing measures immediately if the equipment switch is no longer accessible.



**WARNING!** Never use water to extinguish the equipment on fire. Burning fuel must be extinguished with special extinguishing agents! We recommend that you keep a suitable fire extinguisher within reach in your work area! We recommend to have dry powder fire extinguisher always available.

### Residual risks

**Even if you are operating this equipment in accordance with all the safety requirements, potential risks of injury and damage remain. The following dangers can arise in connection with the structure and design of this equipment:**

1. Health defects resulting from vibration emission if the equipment is used over long periods of time or not adequately managed and properly maintained.
2. Injuries and damage to property due to broken application tools or the sudden impact of hidden objects during use.
3. Danger of injury and property damage caused by flying objects.
4. Burns, if touching hot surfaces.



**WARNING!** This equipment produces an electromagnetic field during operation! This field may under some circumstances interfere with active or passive medical implants! To reduce the risk of serious or fatal injury, we recommend persons with medical implants to consult their doctor and the medical implant manufacturer before operating this equipment!





## Symbols

On the equipment, the rating label and within these instructions you will find among others the following symbols and abbreviations. Familiarise yourself with them to reduce hazards like personal injuries and damage to property.

kW	Kilowatt	l	Litre
cm <sup>3</sup>	Cubic centimetre	ml	Millilitre
min <sup>-1</sup>	Per minute	°C	Degree Celsius
m	Metre	dB(A)	Decibel (A-rated)
mm	Millimetre	m/s <sup>2</sup>	Metres per second squared
cm	Centimetre	kg/h	Kilogram per hour
kg	Kilogram	g/kWh	Gram per kilowatt per hour
yyWxx	Manufacturing date code; year of manufacturing (20yy) and week of manufacturing (Wxx)		

### Description of signal words:

 **DANGER!** The signal word that indicates a hazard with a high level of risk which, if not avoided, will result in death or serious injury.

 **WARNING!** The signal word that indicates a hazard with a medium level of risk which, if not avoided, could result in death or serious injury.

 **CAUTION!** The signal word that indicates a hazard with a low level of risk which, if not avoided, could result in minor or moderate injury.

**NOTE!** Indicates a practical tip, advice or practice not related to personal injury.

  Caution/Warning.  
Read the instruction manual.

 Note/Remark.

 Wear ear protection  
(compliant to EN 352-1)

 Wear protective gloves (compliant to  
EN ISO 21420 Class 0)

 Wear eye protection  
(compliant to EN 166)

 Do not expose the equipment to rain or wet conditions.



Open flames in the work area, around the equipment and in the vicinity of flammable materials are prohibited!



Do not smoke in the work area, around the equipment and in the vicinity of flammable materials!



Risk of fire/flammable materials.



Hot surface, do not touch! High temperatures on the equipment's surfaces and structural parts that could cause burns, if they are touched. The equipment can also stay hot for a longer period of time after the operation!



Petrol engines produce toxic carbon monoxide exhaust fumes. Breathing carbon monoxide can cause nausea, fainting or even death. Do not operate the engine indoors!



Stop the engine before refuelling. Never refuel the equipment while the engine is running.



Only refuel unleaded petrol and oil mixture in ratio 40:1. Do not use any other mixture ratio.



Stop the engine and disconnect the spark plug wire before assembly, cleaning, adjustments, maintenance, storage and transportation.



Blades are sharp. Risk of cuts.



Keep fingers away from the moving cutting device.



Press the primer 6 times before starting the cold engine.



Choke – CLOSE position.



Choke – OPEN position.



Guaranteed sound power level value in dB.

TTHTP26

Designation of the tool  
(**TT**\_Brand Name; **HTP**\_Petrol Hedge Trimmer; **26**\_Engine size in cc)



The equipment complies with the applicable European directives and an evaluation method of conformity for these directives was done.

## Technical specifications

### General

- > **Dimensions:** approx. 127 x 25 x 26 cm
- > **Weight:** approx. 6 kg
- > **Fuel tank capacity:** 460 cm<sup>3</sup> (ml)
- > **Petrol type:** #95, unleaded
- > **Engine oil type:** 2-stroke motor oil
- > **Fuel-oil ratio:** 40:1
- > **Max. cutting length:** 673 mm
- > **Max. cutting capacity:** 28 mm
- > **Handle adjustment:** 3 positions (90°/ 0°/ -90°)

### Engine

- > **Engine model:** SL34G
- > **Engine displacement:** 26 cm<sup>3</sup>
- > **Maximum engine power (in accordance with ISO 8893):** 0.75 kW
- > **Maximum speed at maximum power (rotational frequency):** 8000 min<sup>-1</sup>
- > **Maximum operating engine speed (rotational frequency):** 10000 min<sup>-1</sup>
- > **Idle speed:** 3000 min<sup>-1</sup>
- > **Clutch engagement speed:** 4000 min<sup>-1</sup>
- > **Fuel consumption (in accordance with ISO 8893) at max. engine performance:** 400 kg/h
- > **Specific fuel consumption (in accordance with to ISO 8893) at max. engine performance:** 533 g/kWh
- > **Spark plug type:** CHAMPION RCJ6Y
- > **Spark plug gap:** 0.6 – 0.7 mm

**Sound emission level**

- > **Sound pressure level  $L_{pA}$ :** 94.6 dB(A)
- > **Uncertainty K:** 3 dB(A)
- > **Measured sound power level  $L_{WA}$ :** 105.6 dB(A)
- > **Uncertainty K:** 2.04 dB(A)
- > **Guaranteed sound power level  $L_{WA}$ :** 108 dB(A)

**Vibration emission level**

- > **Hand-arm vibration  $a_{hw}$ :** 7.152 m/s<sup>2</sup> (front handle)  
3.378 m/s<sup>2</sup> (rear handle)
- > **Uncertainty K:** 1.5 m/s<sup>2</sup>

The sound values have been determined according to noise test code given in ISO 10517, using the basic standards ISO 11201 and ISO 3744.

Wear hearing protection, especially when sound pressure is over 80 dB(A).

The declared vibration value has been measured in accordance with a standard test method (according to EN ISO 10517) and may be used for comparing one equipment with another. The declared vibration value may also be used to evaluate the exposure for the user caused by vibration in advance.



**WARNING!** Depending on the actual use of the equipment the vibration values can differ from the declared total. Adopt proper measures to protect yourself against vibration exposures. Take the whole work process including times the equipment is running under no load or switched off into consideration! Proper measures include among others regular maintenance and care of the equipment and accessories, keeping hands warm, periodical breaks and proper planning of work processes!

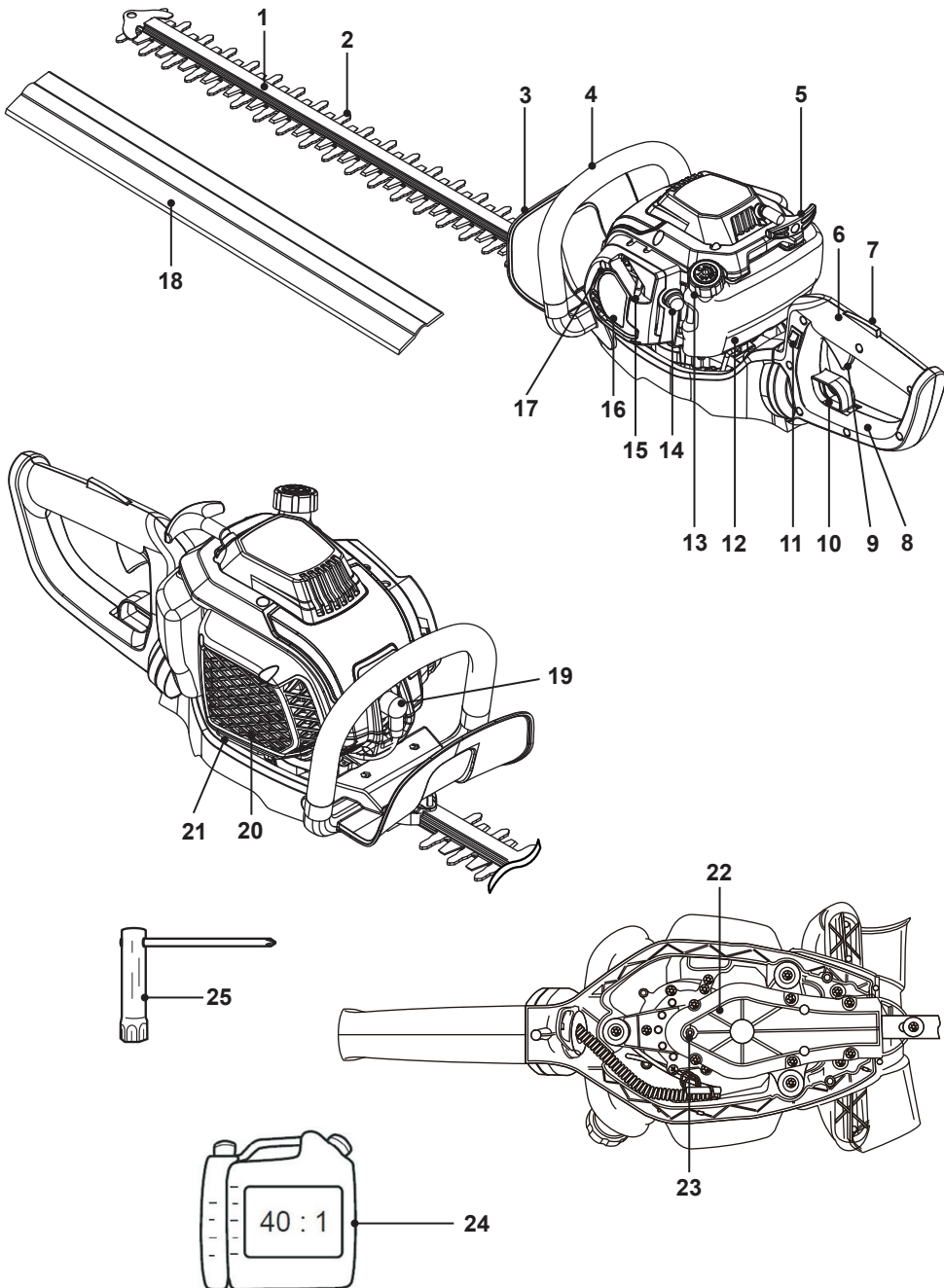

- |                                  |   |
|----------------------------------|---|
| 1. Cutting device                | 14. Primer  |
| 2. Cutter blade                  | 15. Choke lever                                       |
| 3. Front hand barrier            | 16. Air filter case                                   |
| 4. Front handle                  | 17. Fixing screw                                      |
| 5. Recoil starter handle         | 18. Cutting device transport guard                    |
| 6. Rear handle                   | 19. Spark plug wire                                   |
| 7. Throttle control lock-out     | 20. Ventilation openings                              |
| 8. Rear hand barrier             | 21. Exhaust outlet                                    |
| 9. Throttle control              | 22. Gear box  |
| 10. Rear handle adjustment lever | 23. Lubricator  |
| 11. Stop switch                  | 24. Fuel mixing bottle                                |
| 12. Fuel tank                    | 25. Multi-tool (Socket wrench/cross-head screwdriver) |
| 13. Fuel tank cap                |   |

## Unpacking

1. Unpack all parts and lay them on a flat, stable surface.
2. Remove all packing materials and protective shipping materials, if applicable.
3. Make sure the delivery contents are complete and free of any damage. If you find that parts are missing or show damage do not use the equipment and contact your dealer. Using an incomplete or damaged equipment represents a hazard to operators and property.
4. Ensure that you have all the accessories and tools needed for assembly and operation. This also includes suitable personal protective equipment.



**WARNING!** The equipment and the packaging are not children's toys! Children must not play with plastic bags, sheets and small parts! There is a danger of choking and suffocation!

## You will need

### (items not supplied)

- > Suitable personal protective equipment
- > Sharpening set
- > Fuel funnel with filter
- > Suitable 2-stroke motor oil
- > Suitable fuel (#95, unleaded petrol)
- > Container to collect fuel
- > Lubricating gun and lubricant for cutting device

- > First aid kit
- > Dry powder fire extinguisher readily available

### (items supplied)

- > Fuel mixing bottle (24)
- > Multi-tool (25)

## Set up

### Removing the cutting device transport guard



**CAUTION! Risk of cuts!** Cutter blades (2) are very sharp. Wear protective gloves when handling cutter blades (2).

Remove the cutting device transport guard (18) carefully from the cutting device (1) (Fig. 1).

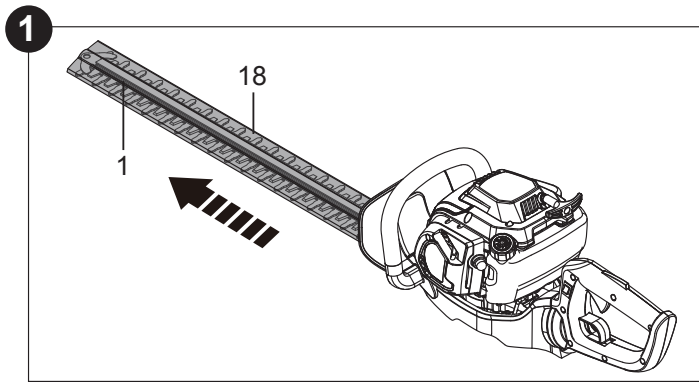

**NOTE:** Always attach the cutting device transport guard (18) back onto the cutting device (1) when the equipment is not in use, and for storage or transportation.

### Adjusting the rear handle



**CAUTION! Risk of loss of balance!** Only adjust the handle position when the engine is switched off.

1. Press and hold the rear handle adjustment lever (10), then rotate the rear handle (6) to the desired position ( $90^\circ$  /  $0^\circ$  /  $-90^\circ$ ) (Fig. 2, 3, 4 and 5).

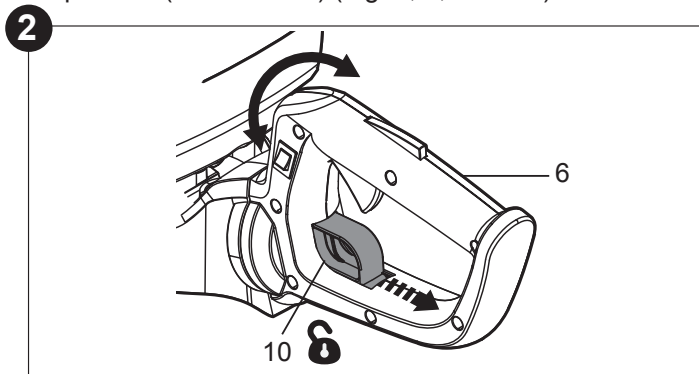

2. Release the rear handle adjustment lever (10) to lock the position in place (Fig. 6).



**NOTE:** The rear handle (6) can only be locked at 3 positions. Make sure it snaps securely into place before operating the equipment.

3

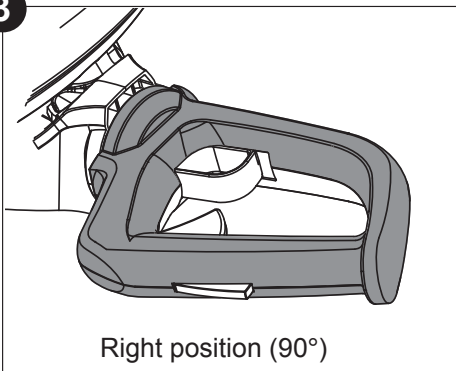

Right position (90°)

4

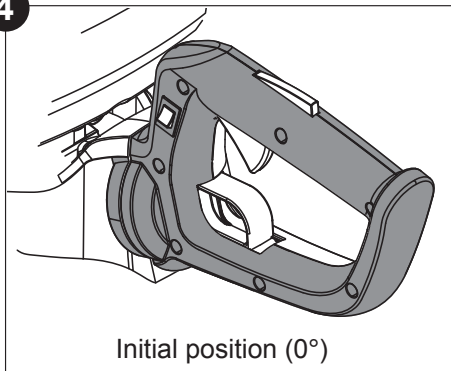

Initial position (0°)

5

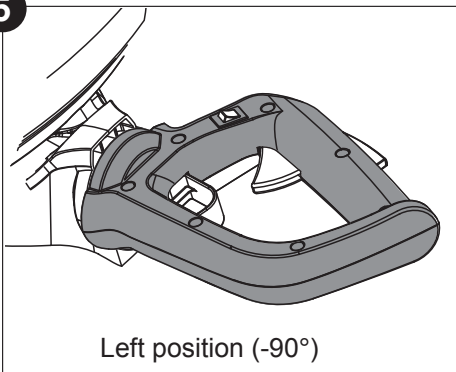

Left position (-90°)

6

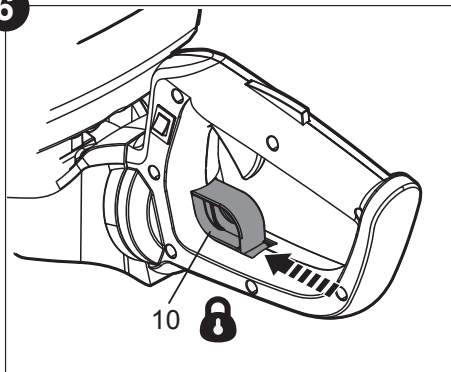

10



## Filling up fuel and oil



**WARNING!** This equipment is not supplied with petrol-oil mixture in the engine! Before operating this equipment it is essential to fill it with petrol-oil mixture!

This equipment is equipped with a 2-stroke engine. The fuel and oil tank are combined and it is essential to fill a fuel-oil mixture before operating this equipment. Observe the technical specifications for suitable fuel and engine oil.



**WARNING!** Fuel and oil are highly inflammable! Fumes will explode if lit! Ensure that there are no naked flames around the equipment! Do not smoke while filling fuel and oil!



**NOTE:** To avoid spillage and to filter out debris, use a funnel with filter to fill the fuel mixing bottle (24) and the fuel tank (12).





1. Place the equipment on a stable, level surface with the fuel tank cap (13) facing upwards. We recommend laying a non-flammable sheet under the equipment.
2. Pour a regular-grade unleaded petrol and a quality engine oil for air cooled 2-stroke engines in the supplied fuel mixing bottle (24) respectively via the 2 openings. Use the scale markings on different sides for the desired ratio for petrol:oil. For example, fill petrol to scale marking "10" first, and then fill 2-stroke oil to scale marking "10". This indicates a correct ratio of 40:1 when using the scale 40:1.
3. Tilt and shake the bottle thoroughly to mix the fuel.



**NOTE:** Use an anti-oxidant added quality oil expressly labelled for air-cooled 2 stroke engine use (JASO FC GRADE OIL or ISO EGC GRADE). Do not use BIA or TWC (2 stroke water-cooling type) mixed oil. The recommended mixing ratio for petrol:oil is 40:1.



**CAUTION! Risk of equipment damage.** Never mix fuel and oil directly in the fuel tank (12).

			=	
100 ml	+	2.5 ml	=	40:1
200 ml	+	5 ml	=	
300 ml	+	7.5 ml	=	
400 ml	+	10 ml	=	

- Unscrew and remove the fuel tank cap (13) (Fig. 7).
- Fill the fuel into the fuel tank (12). Leave approximately 5 mm of space between the top of the fuel and the inside edge of the tank to allow for expansion. Do not overfill (Fig. 8).
- Wipe up spilled fuel with a soft cloth. Refit and screw the fuel tank cap (13) firmly (Fig. 7).

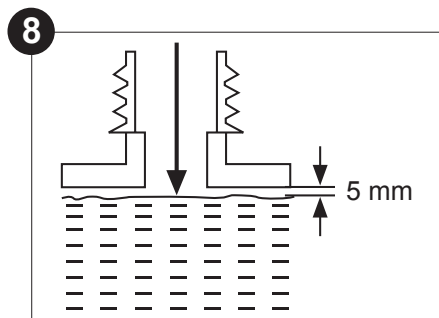
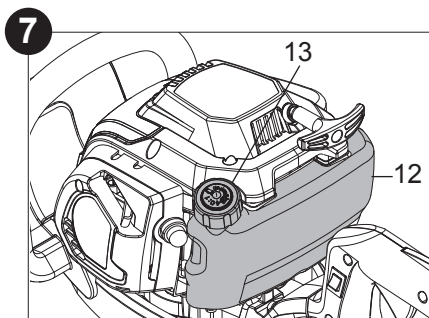

**NOTE:** Fuel and oil deteriorate over time. It may be difficult to start the engine if you use fuel which has been kept for more than 30 days. Towards the end of the season, it is advisable to put only as much fuel in the tank as you need for each use, since it should be completely used up before storing the equipment. Empty remaining fuel from the tank after each use.

# Operating controls



CLOSE



OPEN

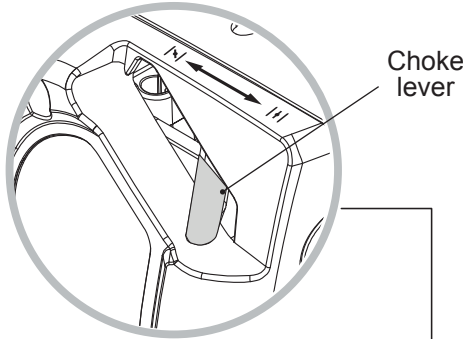

Choke lever

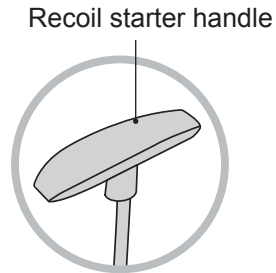

Recoil starter handle

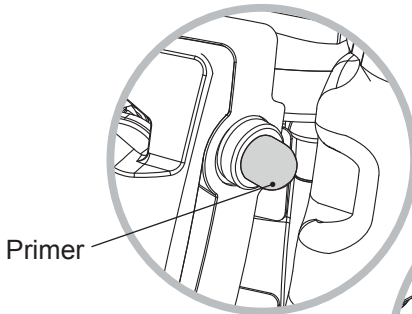
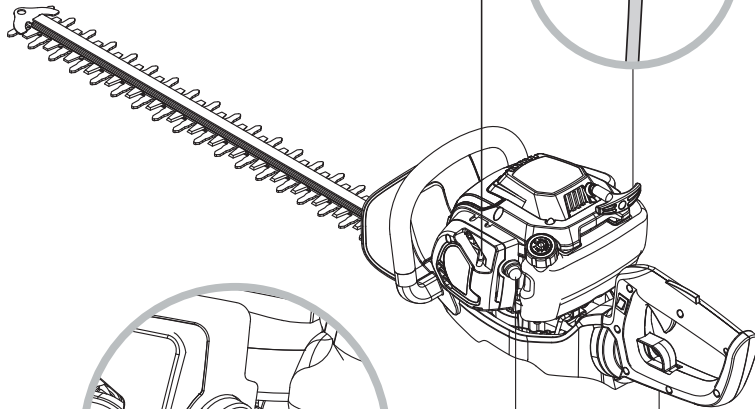

Primer

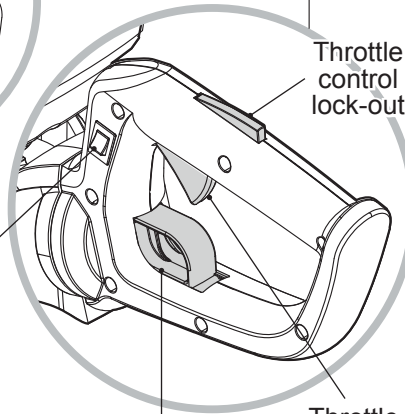

Throttle control lock-out

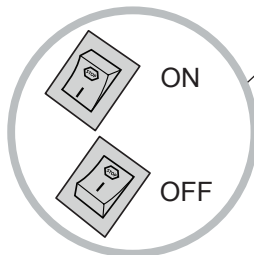

Stop switch

ON

OFF

Unlock lever

Throttle control

## Preparation



Assemble



Adjust



Add fuel and oil  
mixture

## Starting (Cold engine)

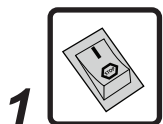

**1**  
Set stop switch  
to I

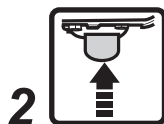

**2**  
Press primer  
6 times



**3**  
Set the choke  
to CLOSE



**4**  
Pull recoil  
starter handle  
3-4 times  
(If engine  
already  
started, skip  
step 6)



**5**  
Set the choke  
to OPEN



**6**  
Pull recoil  
starter handle  
until the engine  
starts



**7**  
Squeeze  
throttle control  
lock-out and  
throttle control  
and release  
them



**8**  
Run idle for  
1-2 minutes

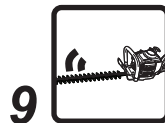

**9**  
Operate

### Starting (Warm engine)

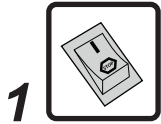

**1** Set stop switch to I

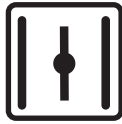

**2** Set the choke to OPEN



**3** Pull recoil starter handle until the engine starts



**4** Squeeze throttle control lock-out and throttle control and release them



**5** Operate

### Stopping



Release throttle control and throttle control lock-out

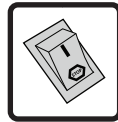

Set stop switch to **STOP**

### Storage



Empty fuel tank



Empty oil



Clean and maintain



Store



**WARNING!** This quick start provides only a short overview of how to start and stop the equipment! For safe use it is essential to read the entire instruction manual before first use!

## Intended use

This petrol hedge trimmer TTHTP26 is designated with a maximum power output of 0.75 kW. This equipment is intended for trimming hedges, bushes and shrubs with a maximum diameter of 20 mm. Do not use the equipment for any other purpose.



**NOTE:** Suggested trimming period:

- > Green leaf hedges (June to October)
- > Evergreens (April and August)
- > Conifers and other fast growing shrubs (every 6 to 8 weeks)



**WARNING!** The equipment must be used by an experienced operator\* having read and understood the safety requirements provided within this instruction manual using appropriate personal protective equipment (PPE)!

This equipment must not be used for cutting other materials, such as plastic, stone, metal, wood that contains foreign objects, or materials that are harmful to health. This equipment should not be used for cutting branches exceeding the stated maximum diameter of 20 mm. For safety reasons it is essential to read the entire instruction manual before first operation and to observe all the instructions therein. This equipment is intended for private domestic use only, not for any commercial trade use. It must not be used for any purposes other than those described.

\* A trained operator is a person who has the competence and knowledge in the use and hazards associated with using a equipment as well as the precautions to be taken to limit these hazards.

## Safety equipment

The equipment has several pieces of safety equipment which reduce the risk of injury when working.

### Hand barrier

- > The front hand barrier (3) and rear hand barrier (8) protects the operator in case of a kickback (Fig. 9 and 10).

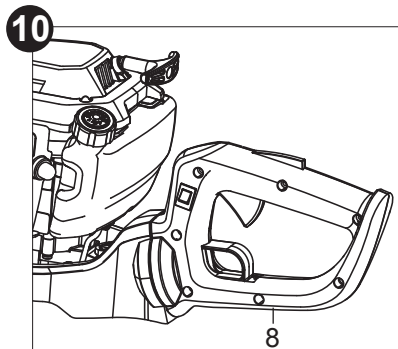
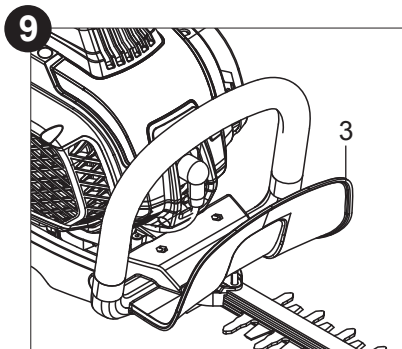

### Throttle control lock-out

The throttle control lock-out (7) prevents unintentional start of the throttle control (9). The throttle control can only be activated if the throttle control lock-out is pressed (Fig. 11).

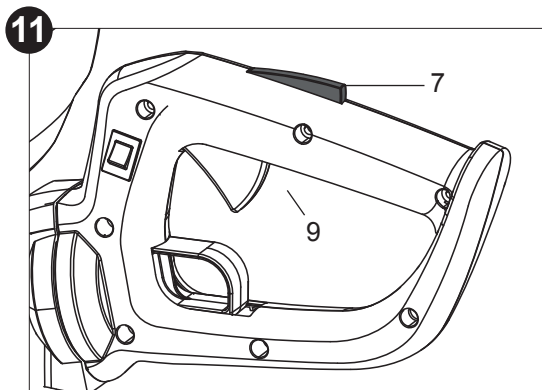

**DANGER! Risk of injury!** The equipment must only be put into operation if no faults are found. If any safety equipment is defective, it must be replaced before the next use.

## Operation

### Check before starting:

1. Check the equipment, as well as accessories for damage before each use. Do not use the equipment if it is damaged or shows wear.
2. Double check that the cutting device (1) is properly fixed, tightened and lubricated.
3. Check the fuel level, refill if necessary.
4. Always hold the equipment by its handles. Keep the handles dry and clean to ensure proper grip.
5. Ensure that the air vents are unobstructed and clear. Clean them if necessary with a soft brush. Blocked air vents may lead to overheating and damage the equipment.
6. Wear correct personal protection equipment to protect yourself from hidden objects that may be thrown from the cutting attachments.
7. Ensure the area to be worked is clear of sticks, wire etc. or other objects that could damage the equipment.
8. Stop the engine immediately if you are disturbed while working by other people entering the working area. Always let the equipment come to complete stop before putting it down.
9. Do not overwork yourself. Take regular breaks to ensure you can concentrate on the work and have full control over the equipment.



**NOTE:** In some countries regulations define at what time of the day and on what special days equipments are allowed to be used and what restrictions apply! Ask your community for detailed information and observe the regulations in order to preserve a peaceful neighbourhood and avoid committing administrative offenses!

## Starting the engine



### **DANGER! Risk of fire!**

- > Due to any spilled fuel, the equipment can catch fire.
- > Wipe any spilled fuel up before starting.
- > Start the engine a few metres away from the place where you have filled it.



### **WARNING! Risk of injury!**

- > Before trying to start the engine, make sure the cutting device does not touch ground or any objects.
- > The cutter blade may start to move during the process of starting. The starting process is NOT finished yet. ALWAYS squeeze and release the throttle control lock-out and throttle control to set the engine run at idle speed! Strictly follow the starting process as instructions!



### **NOTE: Risk of equipment damage!**

Never twist the starter cord around your hand! Only pull on the handle!

Do not suddenly release the recoil starter handle! Allow the rope to return slowly and in a controlled manner each time it is pulled!



**NOTE:** If the engine does not start, the engine may be flooded. Flooding is caused by too much fuel mixture applied at the wrong time and can prevent a equipment from starting. Follow below procedure:

Remove the spark plug and dry the spark plug. Pull the recoil starter handle slowly for several times to drain the fuel from the combustion chamber. Wait until fuel vapours and refit the spark plug. Clean up any spilled fuel and move the equipment at least 3 metres away before starting the engine to avoid any accidental fire. Wait the engine to cool down then cold start or warm start the equipment as described.



## Starting cold engine



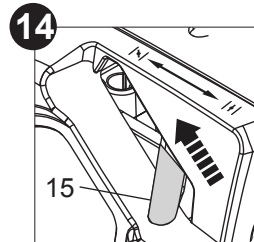
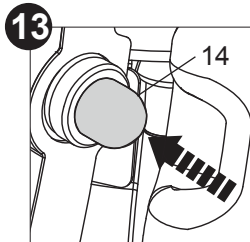
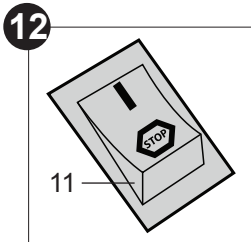

**NOTE:** For a cold start, make sure that the rear handle (6) is in the upright position.

1. Place the equipment on a flat and stable surface. The cutting device (1) should not touch ground or any objects. Set the stop switch (11) to I (Fig. 12).
2. Press the primer (14) 6 times until the bubble is filled with fuel (Fig. 13).
3. Set the choke lever (15) to CLOSE  position (Fig. 14).

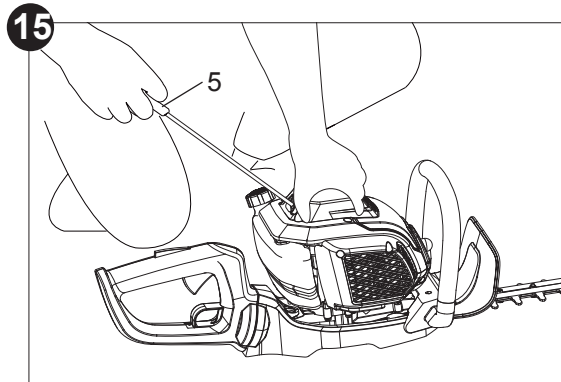

4. Hold the machine securely to the ground with your left hand. Pull the recoil starter handle (5) slowly with your right hand until you feel a definite resistance and then give it a brisk, strong pull. Repeat until the engine attempts to start but no more than 4 times (Fig. 15). (If engine already started within 4 times, ignore step 5, 6 and go to step 7 directly.)



5. Set the choke lever (15) to OPEN  position.
6. Pull the recoil starter handle (5) until you feel a definite resistance. Repeat until the engine starts (Fig. 15).
7. Squeeze the throttle control lock-out (7) and throttle control (9) and release them to let engine run at idle speed.
8. Let the equipment run in idle for 1 to 2 minutes to let it warm up.

## Starting warm engine

1. Place the equipment on a flat and stable surface. The cutting device (1) should not touch ground or any objects. Set the stop switch (11) to I (Fig. 16).
2. Ensure the choke lever (15) is set to OPEN  position (Fig. 17).

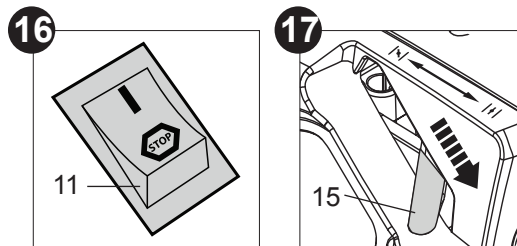

3. Hold the machine securely to the ground with your left hand. Pull the recoil starter handle (5) slowly with your right hand until you feel a definite resistance and then give it a brisk, strong pull. Repeat until the engine starts (Fig. 15).
4. Squeeze the throttle control lock-out (7) and throttle control (9) and release them to let engine run at idle speed.

#### After starting the engine

1. Press the throttle control lock-out (7) and then slowly press the throttle control (9) to increase the engine speed.
2. Check if the cutting device (1) stops moving when you release the throttle control (9).

#### Stopping the engine

1. Release the throttle control (9) and let the equipment run in idle for a while.
2. Set the stop switch (11) to **STOP**.



**WARNING!** The cutting device (1) continues to move for some time after the engine has been switched off. Wait until the cutting device comes to a complete stop before setting the equipment on the ground.

## Trimming tips



**WARNING!** When operating the equipment, always keep the exhaust outlet (21) away from your body (Fig. 18-23).



**NOTE:** Always keep the cutting device (1) at an angle of approximately 15° to the cutting surface.

- > Cut and remove branches exceeding the cutting capacity of this equipment (20 mm) using a proper pruner before operation.
- > Adjust the rear handle (6) so that it fits the intended cut.
- > Start the equipment as described. Press the throttle control lock-out (7), hold it in position and then press the throttle control (9) to engage the cutter blades (2). Operate the engine at full throttle to maintain a proper cutting speed.

- > Move the cutting device (1) lightly through the cutting surface in a sweeping motion following the shape of the hedge or shrub. A slight 15° tilt downwards of the cutting device in the direction of motion is recommended for optimum cutting performance.
- > Do not rush and do not attempt to cut too much with one stroke of the cutting device.

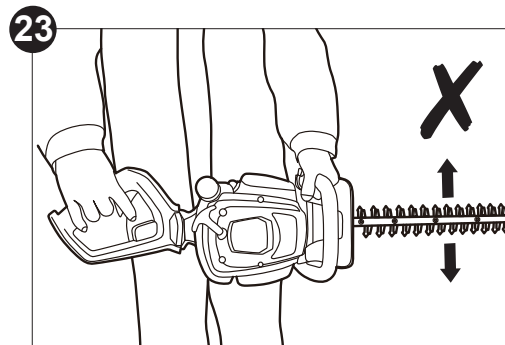
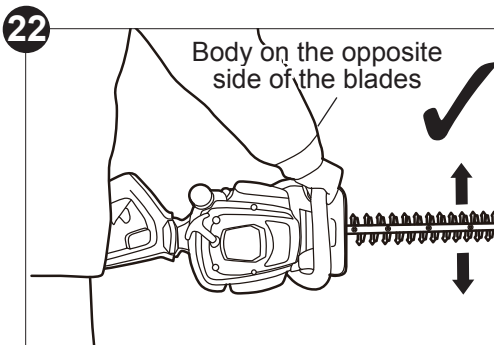
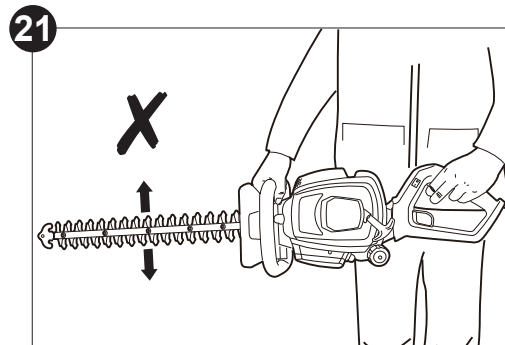
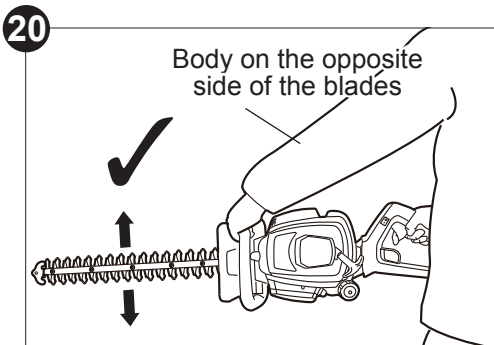
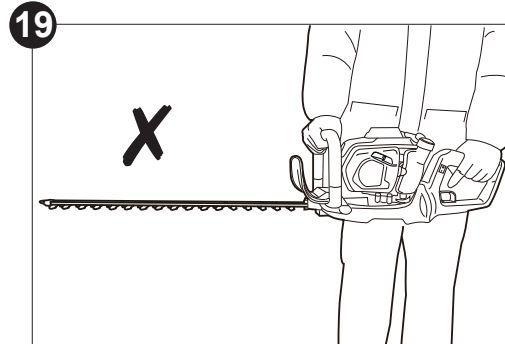
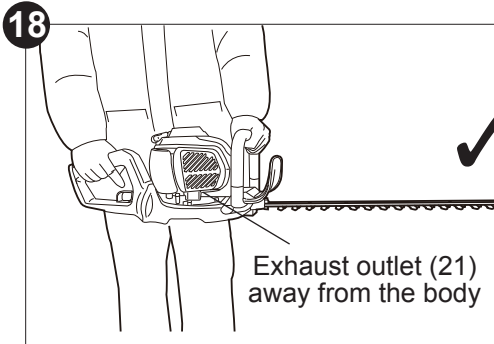

- > For vertical cuts, start the first cut from the bottom cutting upwards to the top. This will prevent any of the trimmings falling into the path of the area still to be cut (Fig. 24).

- > After cutting the sides proceed to the top (Fig. 25). Try to keep the cutting device at an angle of approximately  $15^\circ$  to the cutting surface.
- > Cut in stages if the area being cut is particularly long to achieve a better result; smaller trimmings will allow for easy composting.

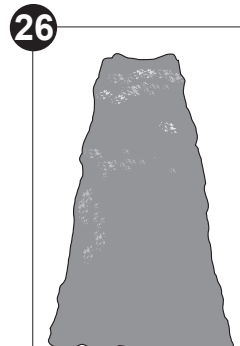
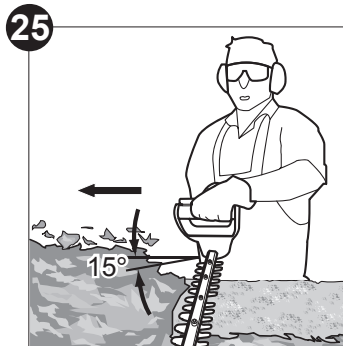
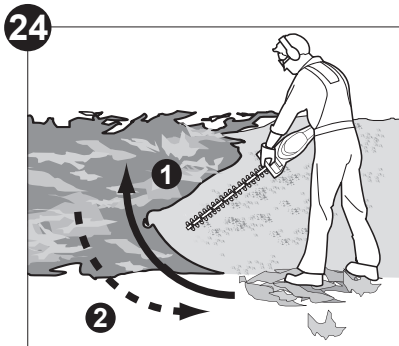

**NOTE:** When shaping it is recommended to achieve a trapezoidal shape (Fig. 26). A trapezoidal cut corresponds to the natural growth of plants and results in optimal hedge growth, as it will expose more light to the lower end of the hedge.

## After use

1. Stop the engine, disconnect the spark plug wire and let the engine cool down.
2. Check, clean and store the equipment as described below.



**WARNING!** The cutting device (1) continues to move for some time after the engine has been switched off. Wait until the cutting device comes to a complete stop before setting the equipment on the ground.

## The golden rules for care



**WARNING!** Always stop the engine, disconnect the spark plug wire (19) and let the engine cool down before performing inspection, maintenance and cleaning work.



**DANGER!** Proper maintenance is essential for safe and trouble free operation. Improper maintenance, or failure to address a problem instantly can cause a malfunction which can result in serious injury or even death.

1. Keep the equipment clean. Remove debris after each use and before storage.
2. Regular and proper cleaning helps to ensure safe operation and prolongs the life of the equipment.
3. Inspect the equipment before each use for worn and damaged parts. Do not operate it if you find broken and worn parts. Replace worn parts as necessary or contact an authorised service centre for repair before using the equipment again.



**WARNING!** Only perform repairs and maintenance work according to these instructions! All other works must be performed by a qualified person!

## Cleaning



**NOTE:** Do not use chemical, alkaline, abrasive or other aggressive detergents or disinfectants to clean this equipment as they might be harmful to its surfaces.

### Cleaning the housing

- > Use a damp, lint-free cloth to clean the housing.
- > Do not immerse the equipment into water or any liquids.
- > Clean the ventilation openings (20) on the bottom and at the side cover of the engine with a soft brush. Clogged ventilation openings (20) might cause the engine to overheat.
- > Use compressed air (max. 3 bar) to remove stubborn dirt.
- > Wipe the surface with a dry cloth afterwards.

### Cleaning the cutting device

- > Keep the cutting device (1) clean and free of debris. Remove trimmings.
- > Keep the cutting device (1) sharp. Have a worn or damaged cutting device replaced with a new one of the same type by an authorised service centre or a similarly qualified person.

- > Apply a small amount of suitable lubricant on the cutting device (1) to retain a good cutting performance (Fig. 27).
- > Tighten loose nuts on the cutting device (1) with a proper wrench (with 5 Nm to 7 Nm) to ensure safe operation (Fig. 28).

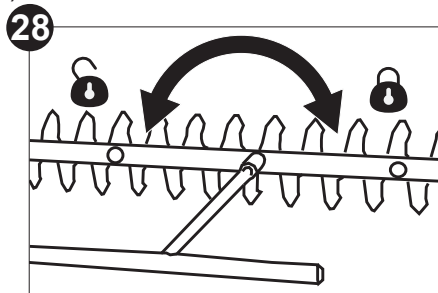
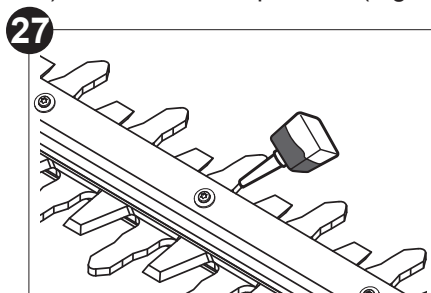

## Maintenance table

Inspect and maintain this equipment regularly based on below maintenance table. Keep the equipment in good working condition during maintenance.

Part	Task	Before/after each use	Every 10 hours of operation	Every 25 hours of operation
Spark plug	check			X
	clean			X
	replace		whenever necessary	
Air filter	check	X		
	clean		X	
	replace		whenever necessary	
Fuel filter and fuel lines	clean		whenever necessary	
	replace		whenever necessary	
Gear box	lubricate			X
Cutting device	check	X		
	lubricate	X		
	clean	X		
	replace/sharpen		whenever necessary	

## Air filter

Inspect the air filter regularly. Clean or replace it with a new one if necessary.

1. Loosen the fixing screw (17) on the air filter case (16) using the multi-tool (25) (Fig. 29).
2. Remove the air filter and tap it on a stable surface to remove dust. Use compressed air (max. 3 bar) to remove stubborn dust.
3. Apply a small amount of air filter oil on the filter to obtain an optimal performance. Wring out surplus oil and put the filter into the case.
4. Refit the filter and refit the air filter case (16).

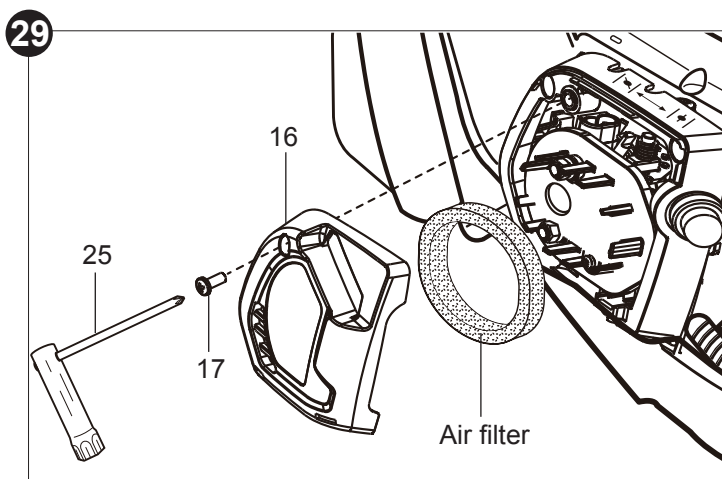

## Fuel, fuel lines and fuel filter

The fuel tank (12) is fitted with a filter located at the free end of the fuel line. If it is necessary to clean or replace the fuel filter, contact an authorised service centre or a similarly qualified person.

- > Keep fuel fresh (less than 30 days) or add fuel stabiliser.
- > Empty the fuel tank after every use.
- > Run the equipment dry of fuel in idle before storage.
- > Replace fuel lines and fuel filter every 2 years.

## Spark plug



**NOTE:** For good performance, the spark plug must be properly gapped and must be free of deposits.

Inspect the spark plug every 25 hours or before long-term storage over 30 days. Clean or replace with a new one if necessary.

1. Unplug the spark plug wire (19) (Fig. 30).
2. Loosen the spark plug anti-clockwise using the multi-tool (25) and remove it carefully (Fig. 31).

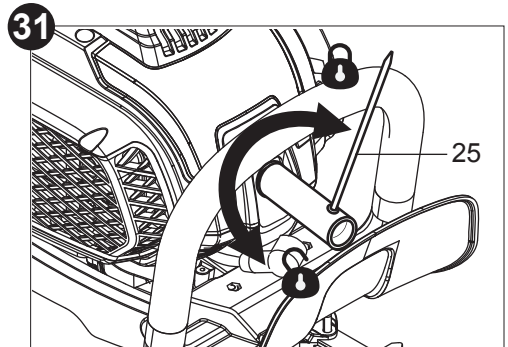
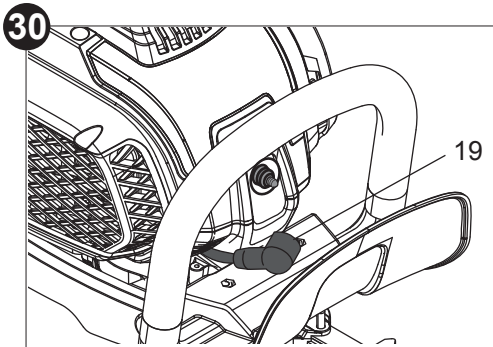

3. Check the spark plug for damage and wear. The colour of the electrode should be light-brown.
4. Remove the deposits from the electrode with a soft wired brush. Avoid heavy cleaning of the electrode.
5. Dry the spark plug with a soft cloth, if it is wet from fuel.
6. Check the spark plug gap. It should be 0.6-0.7 mm (Fig. 32).
7. Replace with a new spark plug if either the electrode or the insulation is damaged.
8. When replacing the spark plug, first screw it in hand tight and then lightly tighten it with the multi-tool (25).

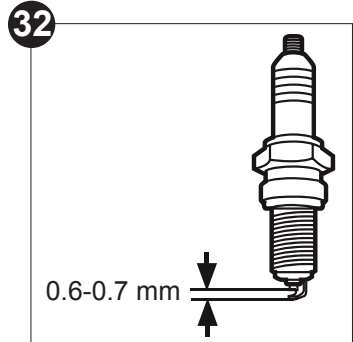

**NOTE:** Do not over tighten the spark plug to avoid any damage!

9. Refit the spark plug wire (19).



## Gear box

- > Lubricate the gear box (22) every 30 hours or more frequent at heavy use.
- > Add grease through the lubricator (23) with an lubricating gun until the grease comes out between the gear box (22) and the cutting device (1) (Fig. 33).

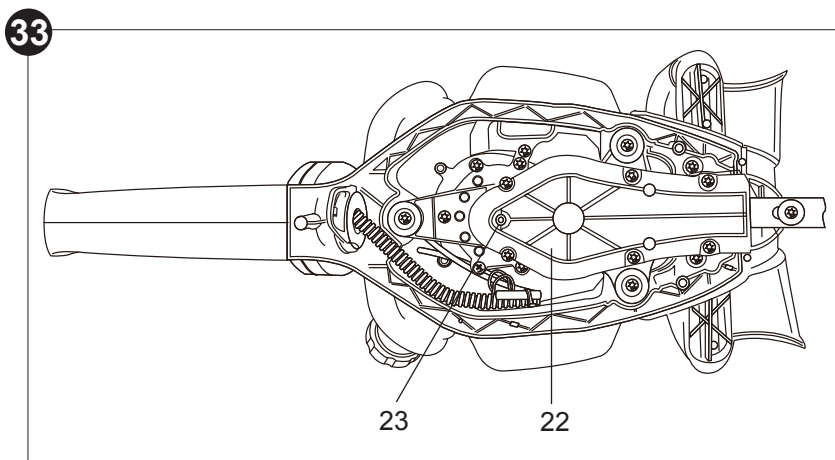

- > Wipe out any excessive grease from the equipment.

## Cutting device

Clean the cutting device (1) regularly. Check it for any damage and protect it from corrosion. If necessary take the cutting device (1) to an authorized dealer for sharpening.

## Carburetor

The carburetor is pre-adjusted by the manufacturer. If it is necessary to adjust the carburetor, contact an authorised service centre or a similarly qualified person. Do not perform any adjustment by yourself.

## Silencer

If it is necessary to adjust or replace the silencer, contact an authorised service centre or a similarly qualified person.

## Spare parts/Replacement parts



**WARNING! Risk of injury!** Use of nonconformant replacement components can result in serious personal injury or death.

The following parts of this equipment may be replaced by the consumer. Spare parts are available at an authorised dealer or through our customer service.

Description	Model no. or Specification
Spark plug	CHAMPION RCJ6Y (Gap of electrodes: 0.6-0.7 mm ) or other model with same specifications

## Repair

This equipment does not contain any parts that can be repaired by the consumer. Contact an authorised service centre or a similarly qualified person to have it checked and repaired.

## Storage



**WARNING! Risk of injury!** Make sure that unauthorized persons do not have access to the equipment!



**NOTE:** Good storage conditions are important for keeping the equipment trouble-free.

1. Clean the equipment as described above.
2. Attach transportation guards, if applicable.
3. Store the equipment and its accessories in a dry, frost-free, well-ventilated place.
4. Always store the equipment in a place that is inaccessible to children. The ideal storage temperature is between 10 and 30 °C.
5. Store the equipment in its bag or cover it with a suitable cloth to protect it against dust.

### Short term storage (less than 1 day)

1. Let the equipment cool down before storage.
2. Store the equipment as horizontally as possible. Make sure that no fuel-oil mixture can run out of the carburetor.

## Long term storage

**NOTE: Risk of equipment damage!**

- > If you are not going to use the equipment for a while, remove the fuel from the equipment. This way, you will prevent a gumming-up of the engine and of the grease pump.
- > Store the equipment in a dry place and far away from possible sources of ignition such as ovens, gas thermostats, etc.

1. Empty the fuel tank (12) using a fuel pump if you are not going to use the equipment for more than 1 day, and especially before winter storage.
2. Start the engine and let it run until the engine stops by itself (see “Starting the engine”).
3. Let the engine cool down (approx. 5 min).
4. Unplug the spark plug wire (19).
5. Let a teaspoon of clean two-stroke engine oil run into the combustion chamber.
6. Pull the recoil starter handle slowly several times in order to coat the internal components with the engine oil.
7. Refit the spark plug wire (19).

## Transportation

1. Stop the engine and disconnect the spark plug wire (19) before transporting the equipment.
2. Attach the cutting device transport guard (18).
3. Always carry the equipment on its handles surfaces.
4. Protect the equipment from any heavy impact or strong vibrations which may occur during transportation in vehicles.
5. Secure the equipment to prevent it from slipping or falling over, loss of fuel, damage and injury.

**If you are transporting the equipment in a vehicle:**

- > Let the equipment cool down.
- > Empty the fuel tank (12).
- > Secure the equipment against slipping using bungee cords (not provided) and vehicle's transportation hooks.

## Troubleshooting

Suspected malfunctions are often due to causes that the operators can fix themselves. Therefore check the equipment using this section. In most cases, the problem can be solved quickly.



**WARNING!** Only perform the steps described in these instructions! All further inspection, maintenance and repair work must be performed by an authorised service centre or a similarly qualified person if you cannot solve the problem yourself!

Problem	Possible cause	Solution
Engine does not start	Fuel tank empty?	Add fuel.
	Stop switch set to <b>STOP</b> ?	Follow the engine starting procedure.
	Incorrect starting procedure?	Follow the engine starting procedure.
	Spark plug wire not firmly attached?	Attach the spark plug wire firmly.
	Spark plug is wet?	Dry the spark plug.
	Spark plug wire is dirty?	Clean the spark plug wire.
	Primer has been pressed at warm start?	Release throttle control lock-out, set the choke to <b>Close</b> position, start engine several times. If the engine does not start: remove spark plug and dry off the electrodes.
	Excess fuel in the combustion chamber?	Remove spark plug and dry off the electrodes.
	Spark plug is soiled (tip is rusted)?	Clean the spark plug.
	Primer has not been pressed at cold start?	Press the primer 6 times and restart. Follow the engine starting procedure.
	Distance from electrode to spark plug too great?	Set the gap between electrodes between 0.6-0.7 mm.
	Incorrect fuel or incorrect mixture?	Stop the engine, empty tank, then fill up with the correct mixture of fuel to oil (40:1).
	Fuel filter clogged?	Have a qualified person clean/replace the fuel filter.
	Spark plug defective?	Replace spark plug.
	Engine cold?	Follow cold starting procedure.
Carburetor setting not correct?	Have a qualified person adjust the carburetor.	

Problem	Possible cause	Solution
Engine does not reach the maximum speed.	Air filter is soiled?	Clean the air filter.
	Incorrect fuel or incorrect mixture?	Stop the engine, empty tank, then fill up with the correct mixture of fuel to oil (40:1).
	Carburetor setting not correct?	Have a qualified person adjust the carburetor.
Engine starts but does not accelerate.	Engine is not warmed up?	Allow engine to warm up at idle speed for 2-3 minutes.
Bad cutting performance.	Cutting device is worn?	Have a qualified person sharpen or replace the cutting device.
	Thickness of the branches exceeds capacity.	Only cut branches with a diameter of maximum 20 mm.
Excessive vibration/noise or smoke.	Cutting device damaged?	Have a qualified person replace the cutting device.
	Nuts on the cutting device loosen?	Stop the engine and re-tighten the loosen nuts.
	Incorrect fuel or incorrect mixture?	Stop the engine, empty tank, then fill up with the correct mixture of fuel to oil (40:1).

## Recycling and disposal

1. Old equipments are potentially recyclable and do not, therefore, belong in your household rubbish. You are requested to assist us and our contribution to saving resources and protecting the environment by handing in this equipment to an equipped collection centre (if there is one available).
2. Petrol, oil, used oil, a mixture of oil and petrol and objects soiled with oil e.g. cleaning cloths do not belong in the household rubbish. Dispose of oil-contaminated items in accordance with the local guidelines and hand them in at recycling centres.
3. The equipment comes in a package that protects it against damage during shipping. Keep the package until you are sure that all parts have been delivered and the equipment is operating properly. Recycle the package afterwards.



(EN) EU DECLARATION OF CONFORMITY  
 (FR) DÉCLARATION UE DE CONFORMITÉ  
 (PL) DEKLARACJA ZGODNOŚCI UE  
 (RO) DECLARAȚIA DE CONFORMITATE UE  
 (ES) DECLARACIÓN UE DE CONFORMIDAD  
 (PT) DECLARAÇÃO DE CONFORMIDADE UE

Product/ Produit/ Produkt/Produsul/Produkt/Producto/Produto

- > Hedge Trimmer/Taille-haie/ Nożyce do żywopłotów/Mășina de tuns garduri vii/ Cortasetos/ Aparador de sebes
- > TTHTP26
- > 26 cm<sup>3</sup>, 0.75 kW
- > 000001 - 999999

Name and address of the manufacturer or his authorised representative:

Nom et adresse du fabricant ou de son mandataire :

Nazwa i adres producenta lub jego upoważnionego przedstawiciela:

Denumirea și adresa producătorului sau a reprezentantului său autorizat:

Nombre y dirección del fabricante o de su representante autorizado:

Nome e endereço do fabricante ou do respetivo mandatário:

Kingfisher International Products B.V.,  
 Rapenburgerstraat 175E,  
 1011 VM Amsterdam,  
 The Netherlands  
[www.kingfisher.com/products](http://www.kingfisher.com/products)

This declaration of conformity is issued under the sole responsibility of the manufacturer.

La présente déclaration de conformité est établie sous la seule responsabilité du fabricant.

Niniejsza deklaracja zgodności wydana zostaje na wyłączną odpowiedzialność producenta.

Prezenta declarație de conformitate este emisă pe răspunderea exclusivă a producătorului.

La presente declaración de conformidad se expide bajo la exclusiva responsabilidad del fabricante.

A presente declaração de conformidade é emitida sob a exclusiva responsabilidade do fabricante.

Object of the declaration/Objet de la déclaration/Przedmiot deklaracji/Obiectul declarației/Gegenstand der Erklärung/Objeto de la declaración/Objeto da declaração

**Product/Produit/Produkt/Produsul/Produkt/  
 Producto/ Produto**

**Model/Modèle/Model/  
 Modelul/Modell/Modelo/  
 Modelo**

**EAN**

Hedge Trimmer/Taille-haie/ Nożyce do żywopłotów/Mășina de tuns garduri vii/ Cortasetos/ Aparador de sebes

TTHTP26

5059340124346

The object of the declaration described above is in conformity with the relevant Union harmonisation legislation:

L'objet de la déclaration décrit ci-dessus est conforme à la législation d'harmonisation de l'Union applicable :  
Wymieniony powyżej przedmiot niniejszej deklaracji jest zgodny z odnośnymi wymaganiami unijnego prawodawstwa harmonizacyjnego:



Obiectul declarației descris mai sus este în conformitate cu legislația relevantă de armonizare a Uniunii:  
El objeto de la declaración descrita anteriormente es conforme con la legislación de armonización pertinente de la Unión:

O objeto da declaração acima descrito está em conformidade com a legislação de harmonização da União aplicável:

2006/42/EC as amended Machinery Directive  
2014/30/EU as amended Directive Electromagnetic compatibility  
2000/14/EC as amended Outdoor Noise Directive  
2016/1628/EU Regulation Gaseous and Particulate Pollutant Emission Limits  
2011/65/EU as amended Directive Restriction of the use of certain hazardous substances in electrical and electronic equipment  
2006/42/CE telle que modifiée Directive sur les machines  
2014/30/UE telle que modifiée Directive Compatibilité électromagnétique  
2000/14/CE telle que modifiée Directive relative aux émissions sonores dans l'environnement des matériels destinés à être utilisés à l'extérieur des bâtiments  
2016/1628/UE Règlement relatif aux exigences concernant les limites d'émission pour les gaz polluants et les particules polluantes  
2011/65/UE telle que modifiée Directive relative à la limitation de l'utilisation de certaines substances dangereuses dans les équipements électriques et électroniques  
2006/42/WE w zmienionej dyrektywie maszynowej  
2014/30 / UE ze zmianami Dyrektywa Kompatybilność elektromagnetyczna  
2000/14/WE w zmienionej dyrektywie w sprawie hałasu na zewnątrz  
2016/1628/UE limity emisji zanieczyszczeń gazowych i cząstek stałych  
2011/65 / UE ze zmianami Dyrektywa Ograniczenie stosowania niektórych niebezpiecznych substancji w sprzęcie elektrycznym i elektronicznym  
2006/42/CE, astfel a fost modificată Directiva privind echipamentele  
2014/30/UE, astfel a fost modificată Directiva privind compatibilitatea electromagnetică  
2000/14/CE, astfel a fost modificată Directiva privind zgomotul în aer liber  
2016/1628/UE Regulamentul privind emisiile de poluanți gazoși și de particule poluante  
2011/65/UE, astfel a fost modificată Directiva privind limitarea utilizării anumitor substanțe periculoase în echipamentele electrice și electronice  
Directiva sobre maquinaria modificada 2006/42/CE  
2014/30/UE modificada Directiva Compatibilidad electromagnética  
2000/14/CE modificada Directiva sobre ruido al aire libre  
2016/1628/Reglamento de la UE Límites de emisiones de contaminantes gaseosos y partículas  
2011/65/UE modificada Directiva Restricción del uso de determinadas sustancias peligrosas en equipos eléctricos y electrónicos  
2006/42/CE como diretiva de máquinas alteradas  
2014/30/UE como alteração da compatibilidade eletromagnética  
2000/14/CE como diretiva de ruído exterior alterada  
Limites de emissão de poluentes gasosos e de poluentes de partículas 2016/1628/REGULAMENTO da UE  
2011/65/UE como restrição diretiva alterada da utilização de certas substâncias perigosas em equipamentos elétricos e eletrônicos

<p>Measured Sound Power Level/ Niveau de puissance acoustique mesuré/ Zmierzony poziom mocy akustycznej/ Nivel de putere acustică măsurat/ Nivel de potencia sonora medido / Nivel de potência sonora medido: 105.6 dB(A)</p>	
<p>Guaranteed Sound Power Level/ Niveau de puissance acoustique garanti/ Gwarantowany poziom mocy akustycznej/ Nivel de putere acustică garantat/ Nivel de potencia sonora garantizado/ Nivel de potência sonora garantido: 108 dB (A)</p>	
<p>Engine Model/ Modèle de moteur/ Model silnika/ Modelul motorului/ Motormodell/ Modelo de motor/ Modelo de motor: SL34G</p>	
<p>References to the relevant harmonised standards used or references to the other technical specifications in relation to which conformity is declared:  Références des normes harmonisées pertinentes appliquées, y compris la date de celles-ci, ou des autres caractéristiques techniques, y compris la date de celles-ci, par rapport auxquelles la conformité est déclarée:  Odwołania do odnośnych norm zharmonizowanych, które zastosowano, wraz z datą normy, lub do innych specyfikacji technicznych, wraz z datą specyfikacji, w odniesieniu do których deklarowana jest zgodność:  Trimiteri la standardele armonizate relevante folosite, inclusiv data standardului, sau trimiteri la celelalte specificații tehnice, inclusiv data specificațiilor, în legătură cu care se declară conformitatea:  Referencias a las normas armonizadas pertinentes utilizadas, incluidas las fechas de las normas, o referencias a las otras especificaciones técnicas, incluidas las fechas de las especificaciones, respecto a las cuales se declara la conformidad:  Referências às normas harmonizadas aplicáveis utilizadas, incluindo a data da norma, ou às outras especificações técnicas, incluindo a data da especificação, em relação às quais é declarada a conformidade:</p>	
<p>EN ISO 10517:2019  EN ISO 14982:2009  EN ISO 3744:1995</p>	
<p>Authorized signatory and technical file holder/  Signataire et responsable de la documentation  technique autorisé/Podmiot uprawniony do  wystawienia i adres przechowywania dokumentacji  technicznej/ Semnatar autorizat și deținătorul  dosarului tehnic/Firmante autorizado y titular del  expediente técnico/ Signatário autorizado e detentor  da ficha técnica:</p>	 <p>David Awe  Group Quality Director  On/le/dnia/la/am/el/em: 18/08/2021</p>
<p>Kingfisher International Products B.V.,  Rapenburgerstraat 175E,  1011 VM Amsterdam, The Netherlands  www.kingfisher.com/products</p>	



 <b>(UK) DECLARATION OF CONFORMITY</b>		
<b>Product</b>		
<ul style="list-style-type: none"> <li>• Brush cutter</li> <li>• TTHTP26</li> <li>• 26 cm<sup>3</sup> , 0.75kW</li> <li>• 000001 - 999999</li> </ul>		
<b>Name and address of the manufacturer or his authorised representative:</b>		
Kingfisher International Products Limited 3 Sheldon Square London W2 6PX United Kingdom		
This declaration of conformity is issued under the sole responsibility of the manufacturer.		
Object of the declaration		
<b>Product</b>	<b>Model</b>	<b>EAN</b>
Hedge trimmer	TTHTP26	5059340124346
The object of the declaration described above is in conformity with the relevant legislation:		
Supply of Machinery (Safety) Regulations 2008 as amended Noise Emission in the Environment by Equipment for Use Outdoors Regulations 2001 as amended The Non-Road Mobile Machinery (Type-Approval and Emission of Gaseous and Particulate Pollutants) Regulations 2018 as amended Electromagnetic Compatibility Regulations 2016 as amended The Restriction of the use of Certain Hazardous Substances in Electrical and Electronic Equipment Regulations 2012 as amended  Measured Sound Power Level: 105.6 dB(A) Guaranteed Sound Power Level: 108 dB(A) Engine Model:SL34G		
References to the relevant designated standards used or references to the other technical specifications in relation to which conformity is declared:		
EN ISO 10517:2019 EN ISO 14982:2009 EN ISO 3744:1995		
Signed for and on behalf of: Kingfisher International Products Limited 3 Sheldon Square London W2 6PX United Kingdom    David Awe Group Quality Director		
		On: <b>18/08/2021</b>

# TITAN

**Manufacturer, Fabricant, Prodecent,  
Hersteller, Producător, Fabricante:**

**UK Manufacturer:**

Kingfisher International Products Limited  
3 Sheldon Square London W2 6PX  
United Kingdom

**EU Manufacturer:**

Kingfisher International Products B.V.  
Rapenburgerstraat 175E 1011 VM Amsterdam  
The Netherlands



[www.diy.com](http://www.diy.com)  
[www.screwfix.com](http://www.screwfix.com)  
[www.screwfix.ie](http://www.screwfix.ie)

To view instruction manuals online,  
visit [www.kingfisher.com/products](http://www.kingfisher.com/products)